

I certify this survey is in accordance with the provisions of Chapter 173-37 of the Ohio Administrative Code.

J. Arthur Temple
J. Arthur Temple
Registered Surveyor #1761
April 2004
Updated January 2016

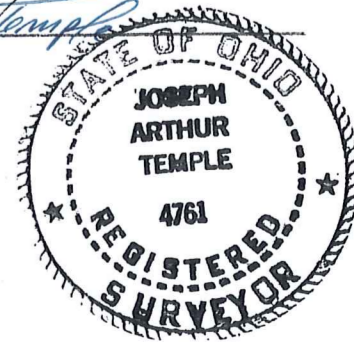

Note: Bearings shown hereon are based on an assumed meridian and are used to indicate angles only.

HAM 00227
HAM00227

Divoky-Divoky (16-002)
Picked Up. 01/27/16
VOL. 2006 pg 999
PN# 15-102612

LOT SPLIT DESCRIPTION
Nicholas Matthew Divoky to Daniel G. Divoky

Situated in the Township of Hambden, County of Geauga and State of Ohio, being part of Original Lot No. 21, Bond Tract of said township and further described as follows:

Beginning in the centerline of Chardon Windsor Road, 60 feet wide, at the northeast corner of land conveyed to Daniel G. Divoky by deed recorded in Vol. 1733, Pg. 870, (P.P. No. 15-102440) of the Geauga County Records of Deeds, said point of beginning also being the northwest corner of land conveyed to Nicholas Matthew Divoky by deed recorded in Vol. 1853, Pg. 2547, (P.P. No. 15-020700) of the Geauga County Records of Deeds, said point of beginning being referenced by a 3/4 inch iron pin found in a monument box, located South 72° 19' 34" East along said road centerline a distance of 612.29 feet;

Thence South 03° 00' 00" West along the common line between P.P. No. 15-102440 and P.P. No. 15-020700, passing thru a 5/8 inch iron pin found at 31.01 feet, a distance of 1121.50 to a 5/8 inch iron pin found at angle point;

Thence North 87° 00' 00" West, continuing along the common line between P.P. No. 15-102440 and P.P. No. 15-020700, a distance of 27.50 feet to a 5/8 inch iron pin set, capped "Temple 4761", at the principal place of beginning of the land to be described herein;

Thence South 18° 22' 35" West, creating a new line, a distance of 103.71 feet to a 5/8 inch iron pin set, capped "Temple 4761" at a point in a common line between P.P. No. 15-102440 and P.P. No. 15-020700;

Thence North 03° 00' 00" East along a line between P.P. No. 15-102440 and P.P. No. 15-020700 line a distance of 100.00 feet to a 5/8 inch iron pin found at an angle point;

Thence South 87° 00' 00" East along line between P.P. No. 15-102440 and P.P. No. 15-020700 a distance of 27.50 feet to the principal place of beginning, containing within said bounds 0.032 acres of land, according to the survey of J. Arthur Temple, Registered Surveyor No. 4761 dated January 2016.

The intent of this description is to divide a 0.032 acre parcel of land from P.P. No. 15-020700 as recorded in Vol. 1853, Pg. 2547 of the Geauga County Records of Deed of Deeds.

Iron pins set are 5/8 inches in dia. by 30 long with orange caps marked "Temple 4761".

Bearings shown herein are based on an assumed meridian and are used to indicate angles only.

Signed: J. Arthur Temple

Date: Jan 2016



SURVEY PLAT & LEGAL DESCRIPTION
APPROVED PER R.C. 315.251
MWS 01/27/16
GEAUGA COUNTY AUDITOR
TAX MAP DEPT. Rev

LOT SPLIT DESCRIPTION
Daniel G. Divoky to Nicholas Matthew Divoky

Situated in the Township of Hambden, County of Geauga and State of Ohio, being part of Original Lot No. 21, Bond Tract in Hambden Township and further described as follows:

Beginning in the centerline of Chardon Windsor Road, 60 feet wide, at the northeast corner of land conveyed to Daniel G. Divoky by deed recorded in Vol. 1733, Pg. 870, (P.P. No. 15-102440) of the Geauga County Records of Deeds, said point of beginning also being the northwest corner of land conveyed to Nicholas Matthew Divoky by deed recorded in Vol. 1853, Pg. 2547, (P.P. No. 15-020700) of the Geauga County Records of Deeds, said point of beginning being referenced by a 3/4 inch iron pin found in a monument box, located South 72° 19' 34" East along said road centerline a distance of 612.29 feet;

Thence South 03° 00' 00" West along the common line between P.P. No. 15-102440 and P.P. No. 15-020700, passing thru a 5/8 inch iron pin found 31.01 feet, a distance of 1021.50 feet to a 5/8 inch iron pin set, capped "Temple 4761", at the principal place of beginning of the land to be described herein;

Thence South 03° 00' 00" West along the common line between P.P. No. 15-102440 and P.P. No. 15-020700, a distance of 100.00 feet to a 5/8 inch iron pin found at an angle point;

Thence North 87° 00' 00" West, continuing along the common line between P.P. No. 15-102440 and P.P. No. 15-020700, a distance of 27.50 feet to a 5/8 inch iron pin set, capped "Temple 4761" at angle point;

Thence North 18° 22' 35" East, creating a new line, a distance of 103.71 feet to the principal place of beginning, containing within said bounds a total of 0.032 acres of land, according to the survey of J. Arthur Temple, Registered Surveyor No. 4761 dated January 2016.

The intent of this description is to divide a 0.032 acre parcel of land from P.P. No. 15-102440 as recorded in Vol. 1733, Pg. 870 of the Geauga County Records of Deeds.

Iron pins set are 5/8 inches in dia. by 30 inches long with orange caps marked "Temple 4761".

Bearings shown herein are based on an assumed meridian and are used to indicate angles only.

Signed: J. Arthur Temple

Date: Jan 2016

SURVEY PLAT & LEGAL DESCRIPTION
APPROVED PER R.C. 315.251
Mews 01 27 16
GAUGA COUNTY AUDITOR
TAX MAP DEPT. *Rev*

